

Front 4-8 Commercial lots for development  
 Either side of Circle is 1.80 acres = 78,504 sf  
 Professional Office, Medical, Bistro type

# FLOOD ZONE X FLOOD INSURANCE "NOT" REQUIRED

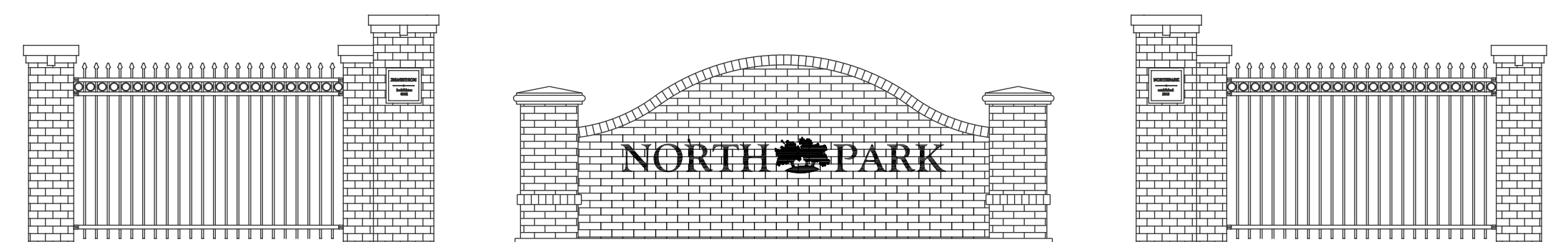

## Settlement at NORTH PARK



104 Rue Richard' @ West Park Ave. =  
 Hwy 24 Gray, Louisiana 70359

[www.northparkhouma.com](http://www.northparkhouma.com) For Complete Details:  
 Covenants & Restrictions, Availability of lots, and Pricing

FOR SALES INFO:  
 Henry J. Richard  
 Cell: 985-856-5203  
[henry@richarddevelopment.com](mailto:henry@richarddevelopment.com)

PHASE 1  
 67 Total lots  
 59 Residential & 8 Commercial  
 38 Estate Lots  
 21 Conventional Lots  
 8 Commercial Lots

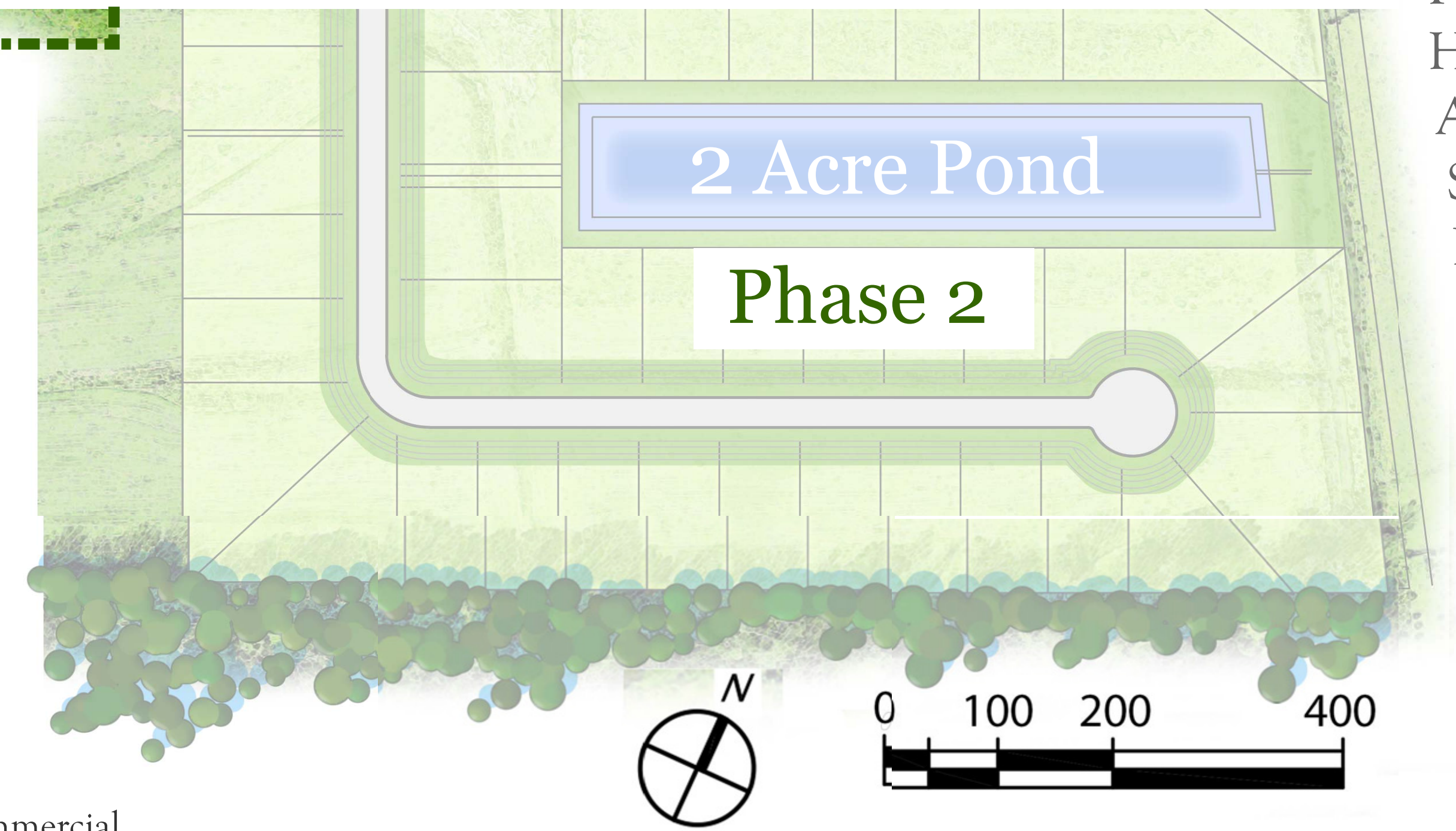

UPDATED ON 04/01/2025